





Internal and external grooving, threading and profiling.

The advantages:

- Grooving, threading and profiling using the same holder.
- Groove widths from 0.031" to 0.375" available.
- Double-sided inserts for twice the productivity.
- Rigid multi-angle clamping system for tough applications.
- PVD coated and uncoated inserts for all materials.

Optimum Grade Performance

Materials	Code		UnCoated PVD	Coated PVD	
	C	ISO	GRADE	GRADE	
			HW HA	HC TP21	
 Unalloyed and Alloyed Steels P	C8	P01			
		P05			
		P10			
	C7	P15			
		P20			
		P25			
	C6	P30			
		P35			
	C5	P40			
		P45			
 Stainless Steels M		M05			
		M10			
		M15			
		M20			
		M25			
		M30			
		M35			
		M40			
	 Cast Irons K	C4	K01		
			K05		
C3		K10			
		K15			
C2		K20			
		K25			
C1		K30			
		K35			
		K40			
 High Temperature Alloys S			S01		
		S05			
		S10			
		S15			
		S20			
		S25			
		S30			



Stell-lok™ Insert Identification System

FN

1

G

2

P

3

30

4

88

5

R

6

1 Type of Insert

FN - Stell-lok™ System

2 Style of Insert

- A - Acme
- B - Blank (for special forms; ground all over except notch)
- D - Threading (drilling industry)
- F - Face Grooving
- G - Grooving
- J - UNJ thread (controlled root radius)
- P - Profile
- R - Full Radius
- V - Poly Vee
- T - Threading

3 Style of Insert (additional Information)

- B - Buttress
- F - Fine Pitch
- S - Stub
- C - Crest Grooving
- P - Positive
- K - Fine Pitch, Positive
- R - Stellram® blank only

4 Insert Size

- 2
- 3
- 4
- 5
- 6

5 Width of Insert Groove

Position pertains to groove width and radii in .001 increments for F, G and R style grooving inserts. (e.g; 1/32" wide groove or radius equals .031 catalog position number).

Position pertains to controlled root radii in .001 increments on FNJ, FNJF, FNJP, FNJK style inserts.

6 Hand of Insert

- L - Left
- R - Right

FNG

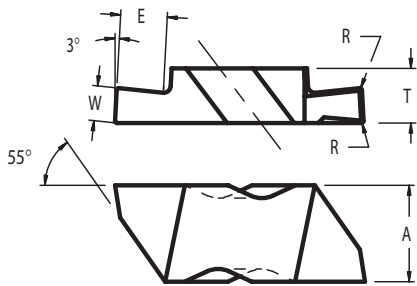

Right Hand Inserts

Description	R	W	T	E	A
FNG2031R	.002/.005	0.031	0.150	0.050	0.219
FNG2041R	.002/.005	0.041	0.150	0.050	0.219
FNG2047R	.002/.005	0.047	0.150	0.050	0.219
FNG2058R	.005/.010	0.058	0.150	0.050	0.219
FNG2062R	.005/.010	0.062	0.150	0.110	0.219
FNG2094R	.005/.010	0.094	0.150	0.110	0.219
FNG2125R	.005/.010	0.125	0.150	0.110	0.219
FNG3047R	.005/.010	0.047	0.195	0.075	0.344
FNG3062R	.005/.010	0.062	0.195	0.094	0.344
FNG3072R	.005/.010	0.072	0.195	0.094	0.344
FNG3078R	.005/.010	0.078	0.195	0.094	0.344
FNG3088R	.005/.010	0.088	0.195	0.094	0.344
FNG3094R	.005/.010	0.094	0.195	0.150	0.344
FNG3097R	.010/.015	0.097	0.195	0.150	0.344
FNG3105R	.005/.010	0.105	0.195	0.150	0.344
FNG3110R	.010/.015	0.110	0.195	0.150	0.344
FNG3122R	.005/.010	0.122	0.195	0.150	0.344
FNG3125R	.005/.010	0.125	0.195	0.150	0.344
FNG3142R	.010/.015	0.142	0.195	0.150	0.344
FNG3156R	.005/.010	0.156	0.195	0.150	0.344
FNG3178R	.005/.010	0.178	0.195	0.150	0.344
FNG3185R	.020/.025	0.185	0.195	0.150	0.344
FNG3189R	.020/.025	0.189	0.195	0.150	0.344
FNG4125R	.005/.010	0.125	0.255	0.150	0.453
FNG4189R	.020/.025	0.189	0.255	0.250	0.453
FNG4213R	.005/.010	0.213	0.255	0.250	0.453
FNG4219R	.020/.025	0.219	0.255	0.250	0.453
FNG4250R	.020/.025	0.250	0.255	0.250	0.453
FNG5250R	.020/.025	0.250	0.380	0.375	0.688
FNG5281R	.030/.035	0.281	0.380	0.375	0.688
FNG5312R	.030/.035	0.312	0.380	0.375	0.688
FNG5375R	.030/.035	0.375	0.380	0.375	0.688
FNG6281R	.030/.035	0.281	0.383	0.250	0.453
FNG6312R	.030/.035	0.312	0.383	0.250	0.453
FNG6344R	.030/.035	0.344	0.383	0.250	0.453
FNG6375R	.030/.035	0.375	0.383	0.250	0.453

Left Hand Inserts

Description
FNG2031L
FNG2041L
FNG2047L
FNG2058L
FNG2062L
FNG2094L
FNG2125L
FNG3047L
FNG3062L
FNG3072L
FNG3078L
FNG3088L
FNG3094L
FNG3097L
FNG3105L
FNG3110L
FNG3122L
FNG3125L
FNG3142L
FNG3156L
FNG3178L
FNG3185L
FNG3189L
FNG4125L
FNG4189L
FNG4213L
FNG4219L
FNG4250L
FNG5250L
FNG5281L
FNG5312L
FNG5375L
FNG6281L
FNG6312L
FNG6344L
FNG6375L

The left hand inserts table includes the same R, W, T, E, A information as the right hand inserts table.

Stell-lok™ Inserts

FNGP

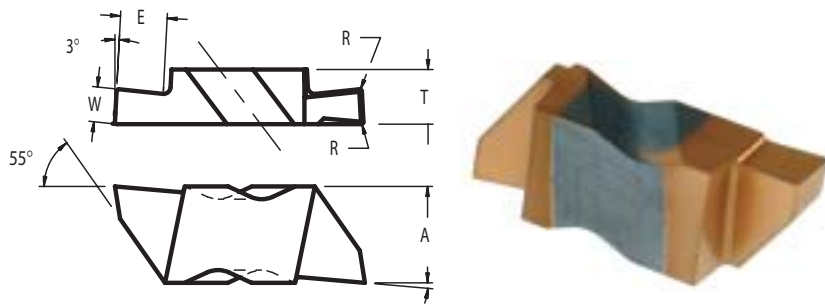

Right Hand Inserts

Description	R	W	T	E	A
FNGP2031R	.002/.005	0.031	0.150	0.050	0.219
FNGP2062R	.005/.010	0.062	0.150	0.110	0.219
FNGP2125R	.005/.010	0.125	0.150	0.110	0.219
FNGP3088R	.005/.010	0.088	0.195	0.094	0.344
FNGP3125R	.005/.010	0.125	0.195	0.150	0.344
FNGP3156R	.005/.010	0.156	0.195	0.150	0.344
FNGP3189R	.020/.025	0.189	0.195	0.150	0.344
FNGP4189R	.020/.025	0.189	0.255	0.250	0.453
FNGP4250R	.020/.025	0.250	0.255	0.250	0.453

Left Hand Inserts

Description
FNGP2031L
FNGP2062L
FNGP2125L
FNGP3088L
FNGP3125L
FNGP3156L
FNGP3189L
FNGP4189L
FNGP4250L

The left hand inserts table includes the same R, W, T, E, A information as the right hand inserts table.

FNP

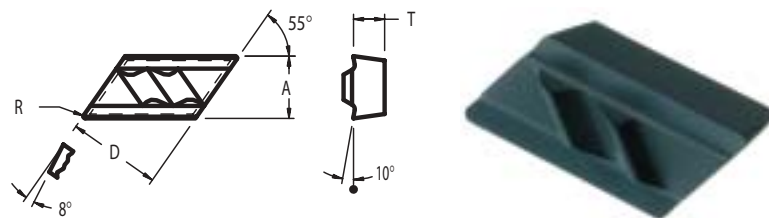

Right Hand Inserts

Description	R	T	D	A
FNPR50.5	0.016	0.125	0.375	0.250
FNPR51	0.016	0.125	0.375	0.250
FNPR52	0.031	0.125	0.375	0.250
FNPR131F	0.016	0.188	0.500	0.375
FNPR331N	0.016	0.188	0.734	0.375
FNPR332N	0.031	0.188	0.734	0.375

Left Hand Inserts

Description
FNPL50.5
FNPL51
FNPL52
FNPL131F
FNPL331N
FNPL332N

The left hand inserts table includes the same R, T, D, A information as the right hand inserts table.

FNT

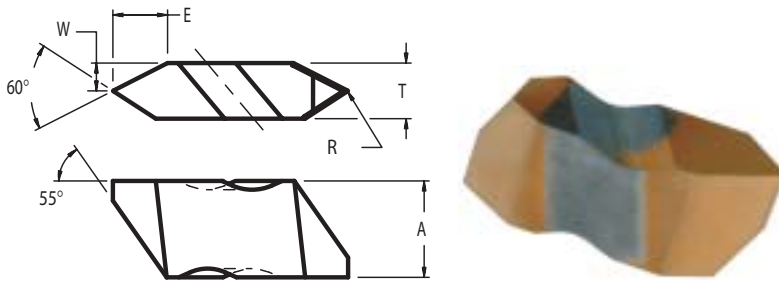

Right Hand Inserts

Description	R	W	T	E	A
FNT2R	.003/.005	0.075	0.150	.114@3°	0.219
FNT3R	.005/.008	0.098	0.195	.146@3°	0.344
FNT4R	.005/.008	0.128	0.255	.194@3°	0.453

Left Hand Inserts

Description
FNT2L
FNT3L
FNT4L

The left hand inserts table includes the same R, W, T, E, A information as the right hand inserts table.

FNTF

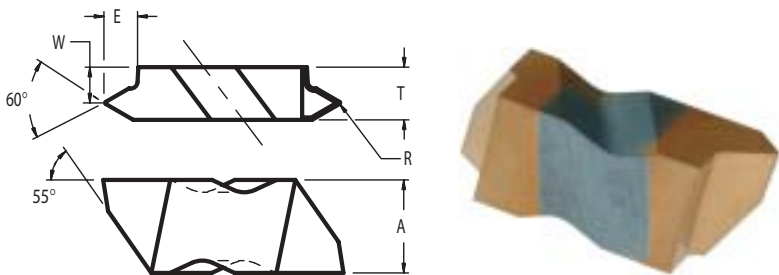

Right Hand Inserts

Description	R	W	T	E	A
FNTF2R	.002/.004	0.110	0.150	.060@3°	0.219
FNTF3R	.002/.004	0.141	0.195	.082@3°	0.344

Left Hand Inserts

Description
FNTF2L
FNTF3L

The left hand inserts table includes the same R, W, T, E, A information as the right hand inserts table.

Stell-lok™ Inserts

FNTP

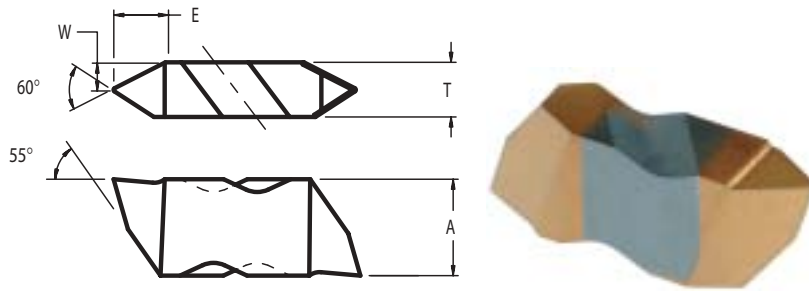

Right Hand Inserts

Description	R	W	T	E	A
FNTP3R	.005/.008	0.098	0.195	.146@3°	0.344
FNTP4R	.005/.008	0.128	0.255	.194@3°	0.453

Left Hand Inserts

Description
FNTP3L
FNTP4L

The left hand inserts table includes the same R, W, T, E, A information as the right hand inserts table.

FNR

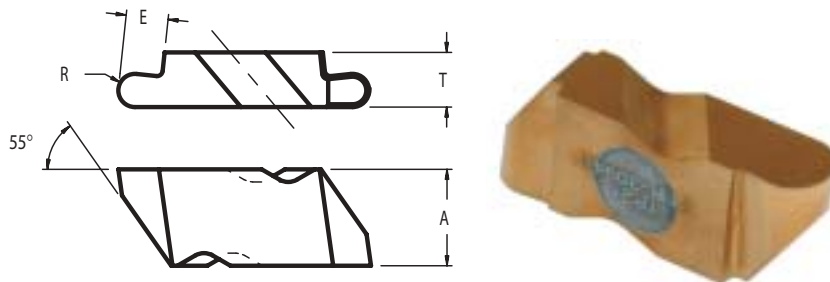

Right Hand Inserts

Description	R	T	D	A
FNR2031R	0.031	0.150	0.110	0.219
FNR2047R	0.047	0.150	0.110	0.219
FNR2062R	0.062	0.150	0.110	0.219
FNR3031R	0.031	0.195	0.094	0.344
FNR3047R	0.047	0.195	0.150	0.344
FNR3062R	0.062	0.195	0.150	0.344
FNR3078R	0.078	0.195	0.150	0.344
FNR3094R	0.094	0.195	0.150	0.344
FNR4062R	0.062	0.255	0.250	0.453
FNR4094R	0.094	0.255	0.250	0.453
FNR4125R	0.125	0.255	0.250	0.453

Left Hand Inserts

Description
FNR2031L
FNR2047L
FNR2062L
FNR3031L
FNR3047L
FNR3062L
FNR3078L
FNR3094L
FNR4062L
FNR4094L
FNR4125L

The left hand inserts table includes the same R, T, D, A information as the right hand inserts table.

FNRP

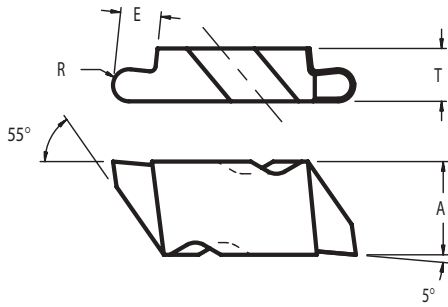

Right Hand Inserts

Description	R	T	E	A
FNRP3031R	0.031	0.195	0.094	0.344
FNRP3047R	0.047	0.195	0.150	0.344
FNRP3062R	0.062	0.195	0.150	0.344
FNRP3078R	0.078	0.195	0.150	0.344
FNRP3094R	0.094	0.195	0.150	0.344
FNRP4062R	0.062	0.255	0.150	0.453
FNRP4094R	0.094	0.255	0.250	0.453
FNRP4125R	0.125	0.255	0.250	0.453

Left Hand Inserts

Description
FNRP3031L
FNRP3047L
FNRP3062L
FNRP3078L
FNRP3094L
FNRP4062L
FNRP4094L
FNRP4125L

The left hand inserts table includes the same R, T, E, A information as the right hand inserts table.

Stell-lok™ Holder Identification System

F
1

N
2

E
3

L
4

16
5 & 6

3
7

D
8

1 Assembly Type

F - Stell-lok™ Clamp

2 Insert

N - Stell-lok™

3 Toolholder Style

AS - Side mount, no offset

E - OS-90 insert position to centerline of tool shank

S - OC - insert parallel to centerline of tool shank

4 Tool Hand

L - Left

R - Right

5 & 6 Shank Size

06 - 3/8" sq.

08 - 1/2" sq.

10 - 5/8" sq.

12 - 3/4" sq.

16 - 1" sq.

20 - 1-1/4" sq.

24 - 1-1/2" sq.

7 Insert Size

2 - 2 series

3 - 3 series

4 - 4 series

5 - 5 series

6 - 6 series

8 Qualification Method & Length

Back to end

A - 4.000" long

B - 4.500" long

C - 5.000" long

D - 6.000" long

E - 7.000" long

F - 8.000" long

G - 5.500" long

H - 9.000" long

K - 12.000" long

L - 14.000" long

V - 3.500" long

Z - End only

Stell-lok™ Toolholders

FNAS

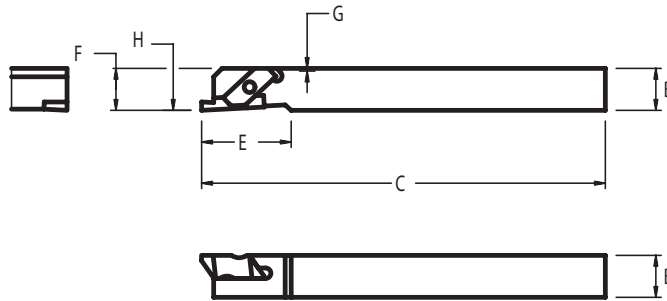

Right hand shown, Left hand opposite

FNAS

Description	Dimensions (inch)					Insert
	B	C	E	F	H	
FNASR/L-062	0.375	6.00	0.855	0.375	0.350	FN_2
FNASR/L-082	0.500	6.00	0.855	0.500	0.350	FN_2
FNASR/L-102	0.625	4.50	0.875	0.625	0.350	FN_2
FNASR/L-122	0.750	5.00	0.875	0.750	0.350	FN_2

SPARES

Part Number	Clamp	Clamp Screw
FNASL-062 to FNASL-082	CM183	#6-32x1/2SHCS
FNASR-062 to FNASR-082	CM182	#6-32x1/2SHCS
FNASL-102 to FNASL-122	CM75	#6-32x1/2SHCS
FNASR-102 to FNASR-122	CM74	#6-32x1/2SHCS

Stell-lok™ Toolholders

FNE

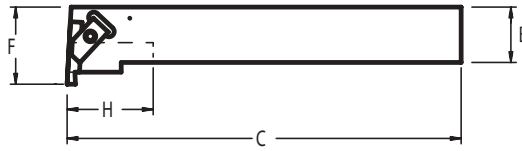
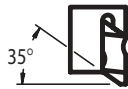

Right hand shown, Left hand opposite

FNE					
Description	Dimensions (inch)				Insert
	B	C	H	F	
FNER/L-123B	0.750	4.50	2.00	1.125	FN_3
FNER/L-163D	1.000	6.00	2.00	1.250	FN_3
FNER/L-203D	1.250	6.00	2.00	1.500	FN_3
FNER/L-164D	1.000	6.00	2.00	1.375	FN_4
FNER/L-204D	1.250	6.00	2.00	1.625	FN_4

Use left-hand insert in right-hand tool; use right-hand insert in left-hand tool.

SPARES		
Part Number	Clamp	Clamp Screw
FNER-123B to FNER-204D	CM73	#10-32X3/4SHCS
FNEL-123B to FNEL-204D	CM72	#10-32X3/4SHCS

Stell-lok™ Toolholders

FNS

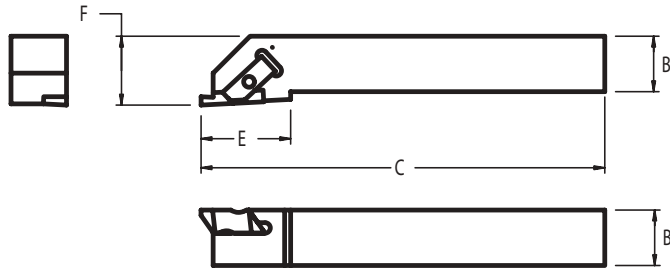

Right hand shown, Left hand opposite

FNS

Description	Dimensions (inch)				Insert
	B	C	E	F	
FNSR-062	0.375	2.50	0.75	0.562	FN_2
FNSR-122B	0.750	4.50	1.25	1.000	FN_2
FNSR-162C	1.000	5.00	0.75	1.250	FN_2
FNSR/L-123B	0.750	4.50	1.25	1.000	FN_3
FNSR/L-163C	1.000	5.00	1.25	1.250	FN_3
FNSR/L-163D	1.000	6.00	1.25	1.250	FN_3
FNSR/L-203D	1.250	6.00	1.25	1.500	FN_3
FNSR/L-164D	1.000	6.00	1.38	1.250	FN_4
FNSR/L-204D	1.250	6.00	1.38	1.500	FN_4
FNSR-244D	1.500	6.00	1.38	2.000	FN_4
FNSR/L-205D	1.250	6.00	2.00	1.500	FN_5
FNSR/L-166D	1.000	6.00	1.38	1.250	FN_6
FNSR/L-206D	1.250	6.00	1.38	1.500	FN_6
FNSR/L-246D	1.500	6.00	1.50	2.000	FN_6

SPARES

Part Number	Clamp	Clamp Screw	Anvil	Anvil Screw
FNSR-062 to FNSR-162C	CM74	#6-32X1/2SHCS	-	-
FNSR-123B to FNSR-203D	CM73	#10-32X3/4SHCS	-	-
FNSL-123B to FNSL-204D	CM72	#10-32X3/4SHCS	-	-
FNSR-164D to FNSR-203D	CM73	#10-32X3/4SHCS	SM420	SL-344
FNSL-164D to FNSL-204D	CM72	#10-32X3/4SHCS	SM420	SL-344
FNSR-205D	CM81	5/1618X1SHCS	-	-
FNSL-205D	CM80	5/1618X1SHCS	-	-
FNSR-206D to FNSR-246D	CM120	#10-32X3/4SHCS	SM416	440X3/8FHCS
FNSL-206D to FNSL-246D	CM121	#10-32X3/4SHCS	SM416	440X3/8FHCS

Stell-lok™ Toolholders

S-FNE

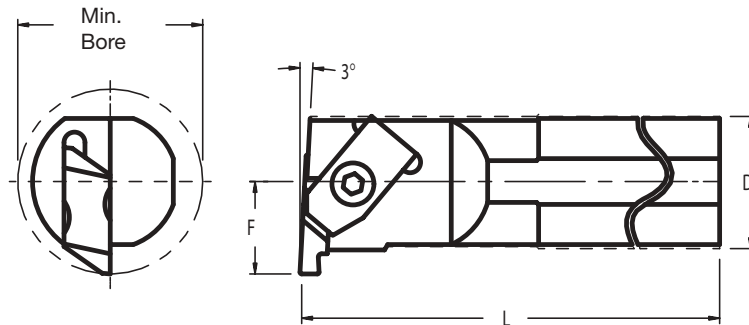

S-FNE					
Description	Dimensions (inch)				Insert
	D	L	F	Min. Bore	
S10FNER2	0.625	10.00	0.500	1.00	FN_2
S16FNEL3F	1.000	8.00	0.688	1.37	FN_3
S16FNER3	1.000	8.00	0.688	1.37	FN_3
S20FNER3	1.250	14.00	0.875	1.75	FN_3
S24FNER3	1.500	14.00	1.000	2.00	FN_3
S28FNER3	1.750	12.00	1.125	2.25	FN_3
S32FNEL5	2.000	16.00	1.406	2.812	FN_5
S32FNER5	2.000	16.00	1.406	2.812	FN_5
S32FNEL6	2.000	16.00	1.375	2.75	FN_6
S32FNER6	2.000	16.00	1.375	2.75	FN_6

Use left-hand insert in right-hand tool; use right-hand insert in left-hand tool.

SPARES		
Part Number	Clamp	Clamp Screw
S10FNER2	CM75	#6-32X1/2SHCS
S16FNEL3F	CM72	#10-32X3/4SHCS
S16FNER3 to S28FNER3	CM73	#10-32X3/4SHCS
S32FNEL5	CM80	5/1618X1SHCS
S32FNER5	CM81	5/1618X1SHCS
S32FNEL6	CM120	#10-32X3/4SHCS
S32FNER6	CM121	#10-32X3/4SHCS